



## 20 Agricola Court

South Shields, NE33 2BX

£154,950



Delighted to offer this 'jewel in the crown of a location', perfect for the town centre, yet private in position and offering family sized three bed roomed accommodation with a lovely sized detached garage at the rear. Rare to the market, this well loved home offers a degree of potential to upgrade and personalise, comes with a fitted kitchen, has a great sized lounge diner and a practical shower room. With loads of cupboard space and a useful cloaks WC, benefits include double glazing and central heating. The home comes with a front garden from a pedestrianised frontage, and has the garage and rear patio garden. A whole lot of home in a great location and one not to be missed.



### Entrance hall

Stairs to the first floor with cupboard under and a built in hall cupboard, radiator

### Cloaks WC

Wash basin and WC

### Lounge dining room

From front to the rear of the home with a stone fireplace and two radiators

### Rear lobby

Laminate floor and door to the rear garden

### Kitchen

Fitted with wall and base units with work surfaces housing a sink unit, electric hob with oven under and filter hood over, tiled splash backs and laminate floor

### First floor

Landing with a large double cupboard.

### Bedroom

Built in cupboard, radiator

### Bedroom

Built in cupboard, radiator

### Bedroom

Radiator

### Shower room

Shower enclosure having a mixer shower with both drencher and spray shower heads, vanity wash basin and WC, part clad walls .

### Garage

A single detached garage to the rear with an up and over door and courtesy door

### External

Front garden from a pedestrianised frontage. To the rear is and enclosed patio yard/garden area.

### Note

Freehold Title, Council Tax Band A, Mains Services Connected, Flood Risk very low. Broadband Basic 16 Mbps, Superfast 80 Mbps, Ultrafast 1000 Mbps. Satellite/Fibre Tv Availability BT, Sky and Virgin. Mobile Coverage O2 and Vodafone likely, EE and Three limited.

### Area Map

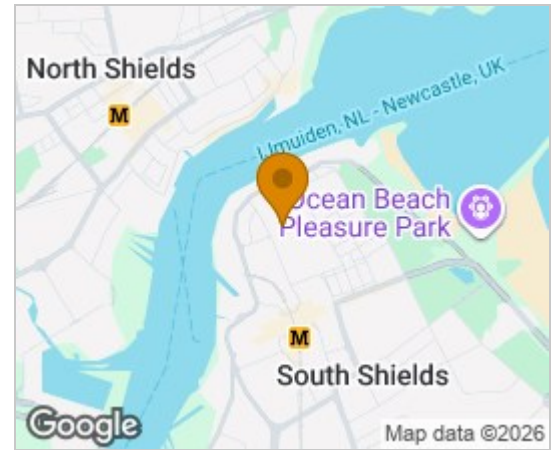

### Floor Plans

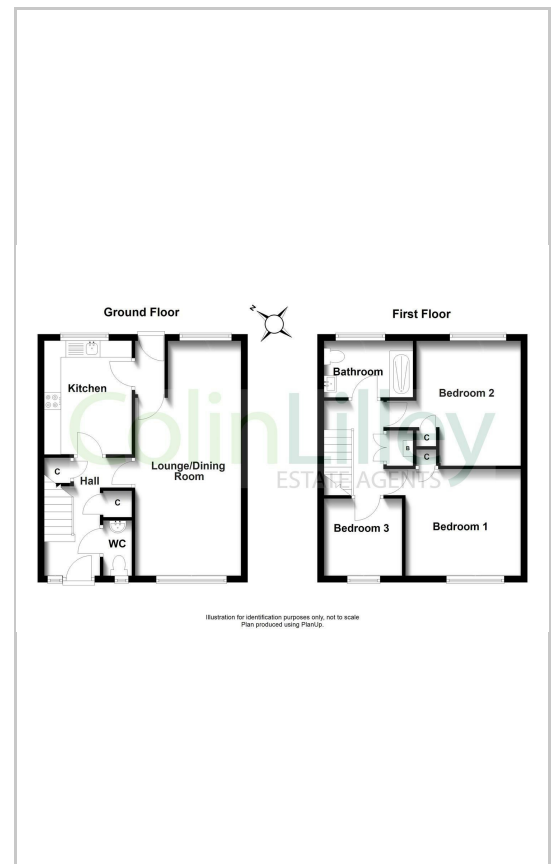

### Energy Efficiency Graph

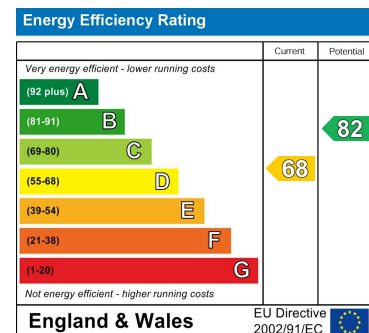

These particulars, whilst believed to be accurate are set out as a general outline only for guidance and do not constitute any part of an offer or contract. Intending purchasers should not rely on them as statements of representation of fact, but must satisfy themselves by inspection or otherwise as to their accuracy. No person in this firms employment has the authority to make or give any representation or warranty in respect of the property.